



# Southfield Farm Caravan Park

Length of Time	Price
1 Day	£7
3 Days	£14
7 Days	£19
1 Month	£29
Touring Season	£90
Static Season	£120

Once purchased vouchers are non-refundable

## Support

**Tel: 01253 501655 available 24/7**

or you can email support on:  
[support@infinium.co.uk](mailto:support@infinium.co.uk)

You can also come into the office for help with logging in.

A G Hicks Ltd  
Southfield Farm Caravan Park  
Weston Road  
Brean  
Burnham-on-Sea  
TA8 2RL

Tel: 01278 751233  
Email: [office@southfield-farm.co.uk](mailto:office@southfield-farm.co.uk)  
Website: [www.southfield-farm.co.uk](http://www.southfield-farm.co.uk)

Company No. 00555369  
Registered Address: 80 Oxford Street, Burnham-on-Sea, Somerset, TA8 1EF



Park Wi-Fi



The public Wi-Fi provided across the park is very different from your home broadband and does not work in the same way.

One account entitles you to use **up to three devices**. Play-stations, Smart TVs and other similar machines without web browsers are not supported.

### Connect on Android Devices

Make sure that your Wi-Fi is turned on.

Connect to the network called 'Southfield Farm'

The Southfield Farm logon page will normally load when you press the grey notification sign in bar (see image) or when you open a new page in your internet browser for example Chrome. If you have trouble try reloading the page.

### First Time User

If this is your first time using the Wi-Fi then press the 'Register' button and enter your email address and the new password you want to use. Agree to the terms and conditions by ticking the box then press the green 'Next' button to go the next screen where you can activate a voucher (purchase in Reception) or buy time using PayPal.

### Existing User

Enter the email address and password you signed up with into the email box and press the green 'Start Browsing' button. You need to use the same email address and password on all three devices.

### Connect on Apple Devices

The process is the same as above but you will need to open a new page in Safari to be taken to the Southfield Farm Logon Page

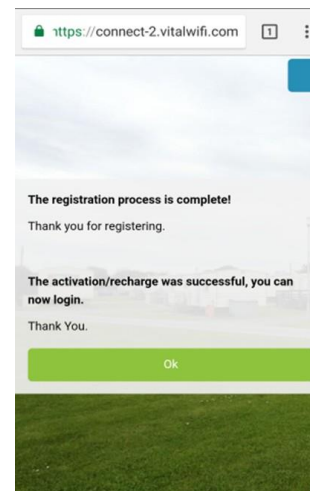
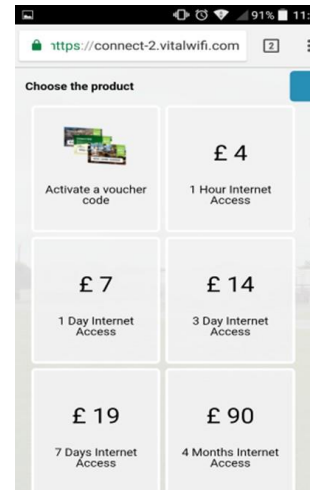
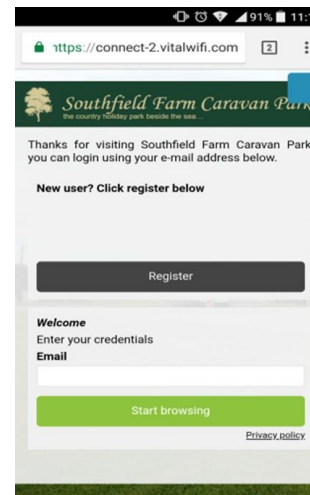
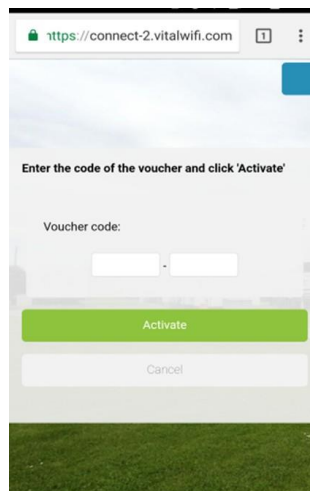
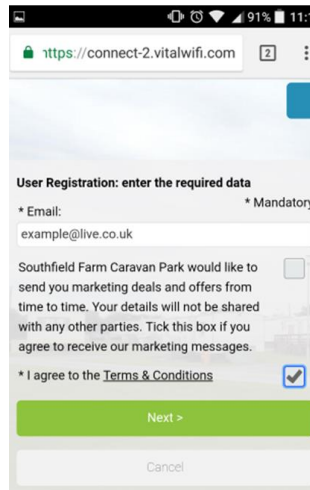
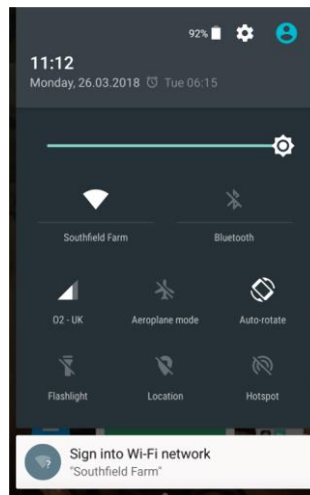

## FAQ

### Q. How many devices can I use?

You may use up to three devices per account (email and password). If you wish to use more than three devices you must purchase another voucher.

### Q. What devices are compatible?

All devices that have a web browser are compatible with the WiFi, i.e. Laptops, Smartphone's, iPad's etc. Play-stations, smart TVs, games consoles and similar devices without web browsers are not compatible.

### Q. When does the internet time start?

The clock starts from the time you have logged into the internet and will expire when the duration of time purchased has elapsed. So, if you login a 1 day voucher in at 10 am one morning it will expire at 10 am the following day.

### Q. How secure is it?

The network is one of the most secure available for public access. We recommend you take some basic steps to protect your device such as keeping your anti-virus and firewall up to date.